

**Coco & Company**  
**Wayne Lawrence Coco, AIA, Architect,**  
**L.L.C.**

**Simmesport Office:**

**510 Main St.**

**Simmesport, Louisiana 71369**

**Telephone: 318-941-2392**

**Fax: 318-941-2821**

**[waynecococo@centurytel.net](mailto:waynecococo@centurytel.net)**



a professional architectural company

**Coco & Company**



Wayne Lawrence Coco & Company  
WAYNE LAWRENCE COCO, AIA,  
ARCHITECT, L.L.C.

# BIENVILLE PARISH LIBRARY

## GIBSLAND BRANCH





DESOTO PARISH LIBRARY \_ LOGANSFORT BRANCH



CLAIBORNE PARISH LIBRARY HEADQUARTERS  
HOMER, LOUISIANA



CLAIBORNE PARISH LIBRARY HEADQUARTERS  
HOMER, LOUISIANA









DESOTO PARISH LIBRARY









Coco & Company

**BIENVILLE PARISH LIBRARY**  
Additions and Renovations to the Ringgold Branch



PROPOSED SIMMESPORT STATE BANK BRANCH



PROPOSED SIMMESPORT STATE BANK BRANCH

# AVOUELLES PARISH JUSTICE CENTER



Coco & Company  
WAYNE LAWRENCE COCO, AIA,  
ARCHITECT, L.L.C.

# AVOYELLES PARISH JUSTICE CENTER

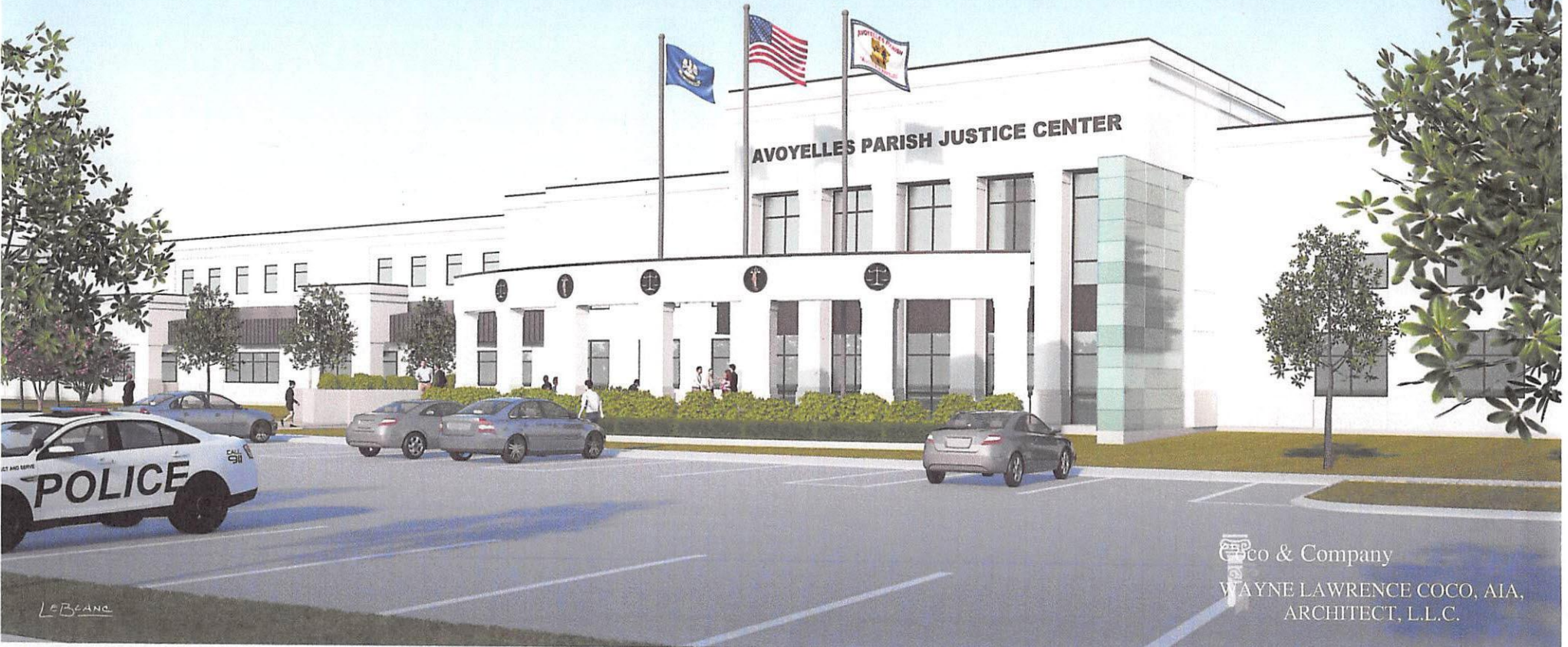

LEBEANO

Coco & Company  
WAYNE LAWRENCE COCO, AIA,  
ARCHITECT, L.L.C.





TUNICA - BILOXI  
TRIBE OF LOUISIANA

# NEW AVOYELLES HOSPITAL FRONT ENTRY AND BUSINESS OFFICE



FOR ALLEGIANCE HEALTH MANAGEMENT  
DESIGNED BY COCO & COMPANY  
WAYNE LAWRENCE COCO, AIA, ARCHITECT





W. Lawrence Co., Inc.  
ARCHITECTS, P.C.

# NORTHWESTERN STATE UNIVERSITY EAST CASPARI HALL RENOVATION NATCHITOCHEES, LOUISIANA



WAYNE LAWRENCE COCO, AIA, ARCHITECT, L.L.C.

Coco & Company



a professional architectural company



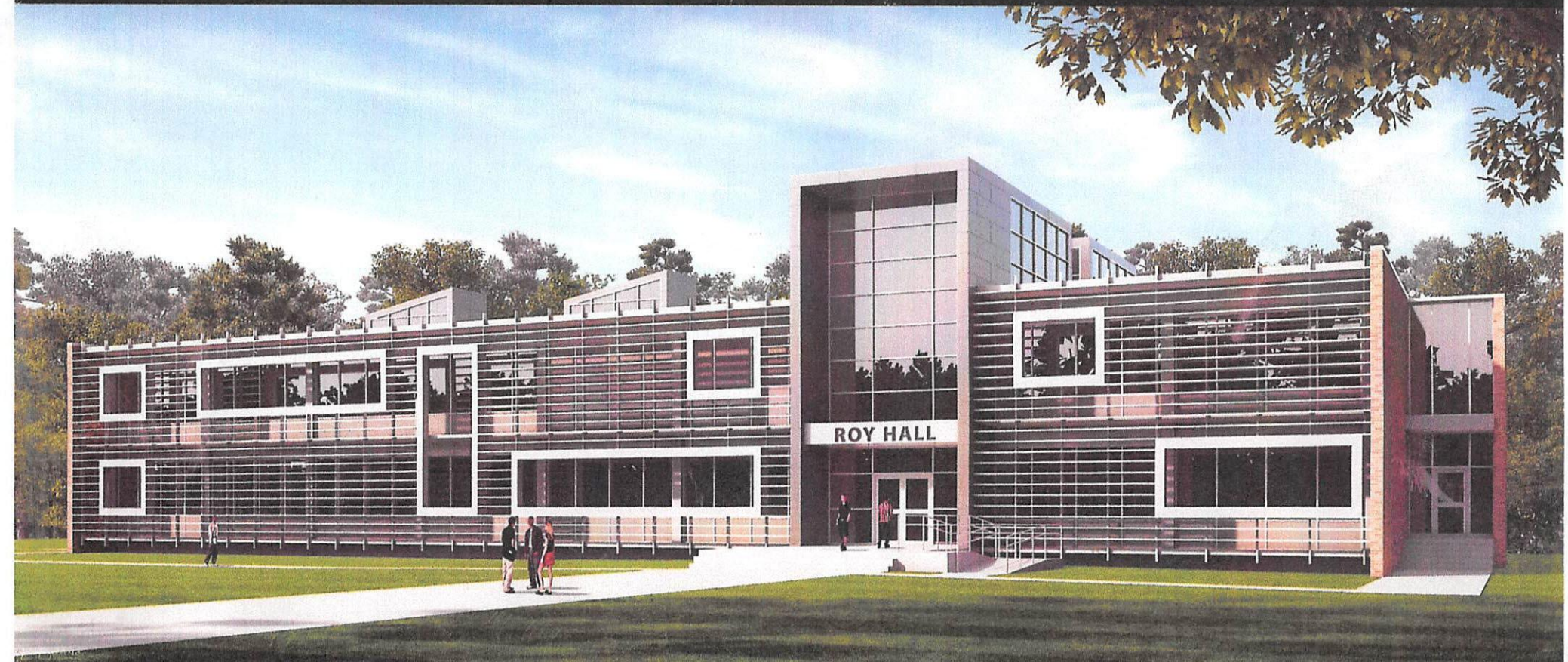

EXTERIOR VIEW - 2

# NORTHWESTERN STATE UNIVERSITY - ROY HALL RENOVATION

NATCHITOCHEs, LOUISIANA  
05.01.2013



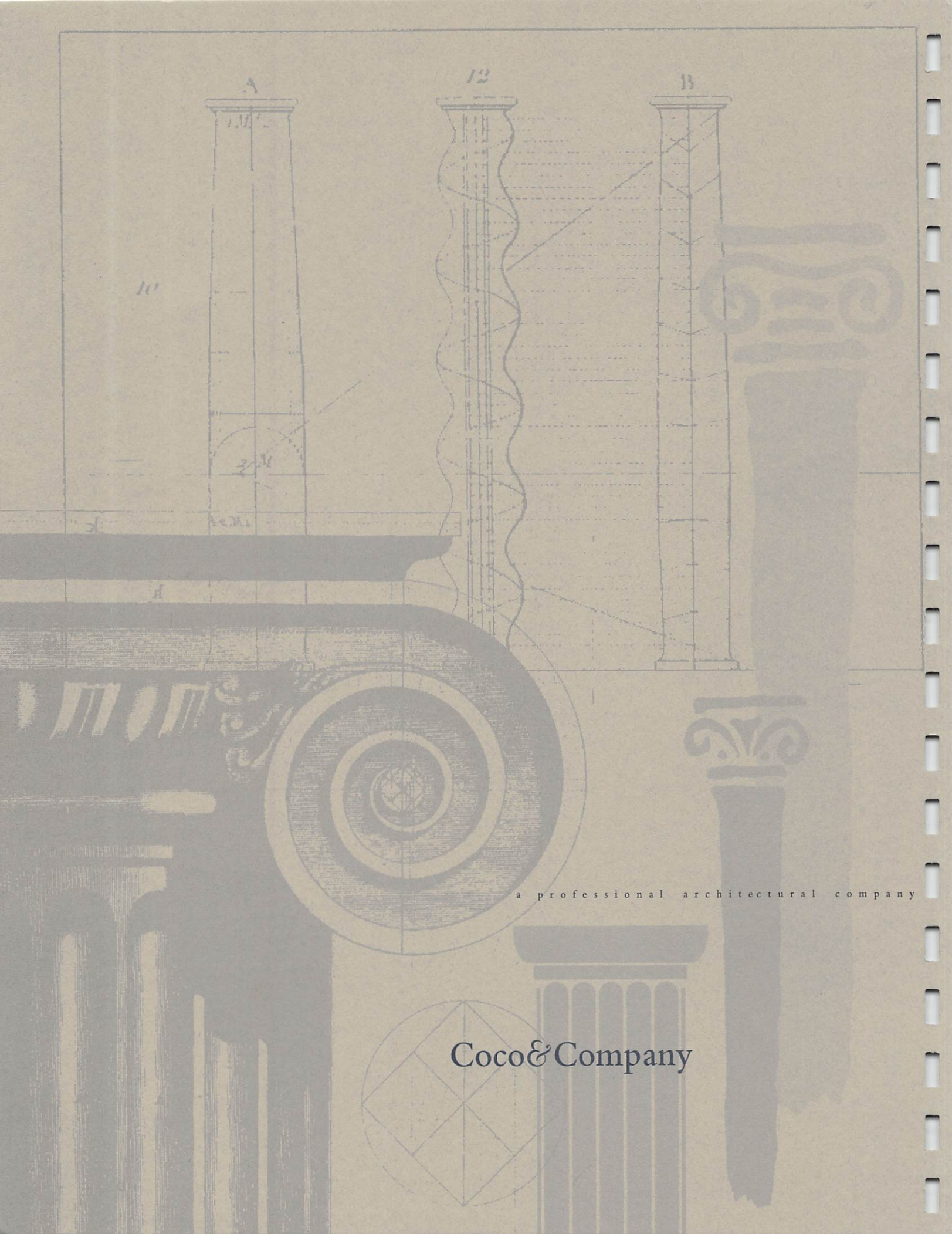

A

12

B

10

a professional architectural company

Coco & Company